



STEP Systems ZEUS STEP Packages

ZS-400

Features

- Ideal for repairs and sites with limited space
- Includes a 10, 20 or 30 gpm high head filtered turbine pump
- Additional risers may be added for deeper installations
- Designed for higher performance onsite systems where high heads are required
- Small lift station may be used to provide small doses to a disposal field
- Includes all components required to install a pump outside a tank

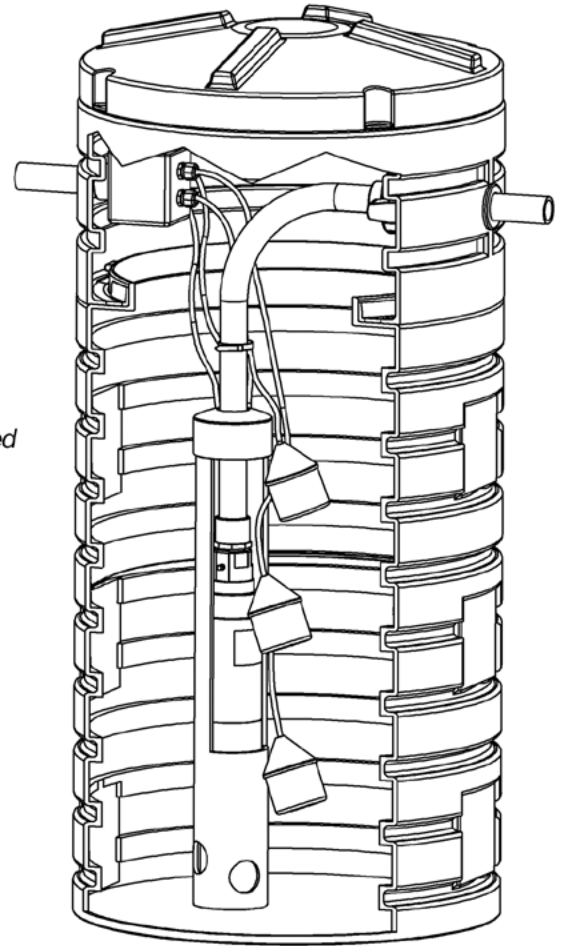
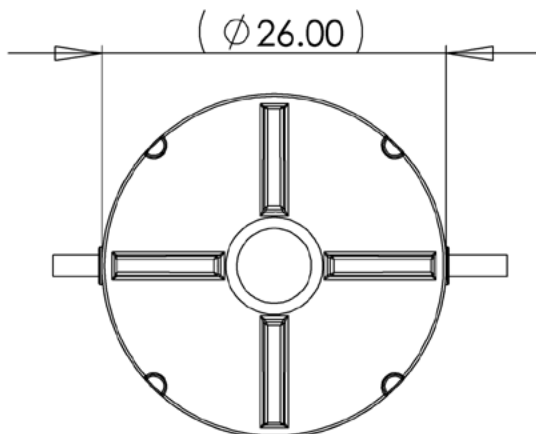
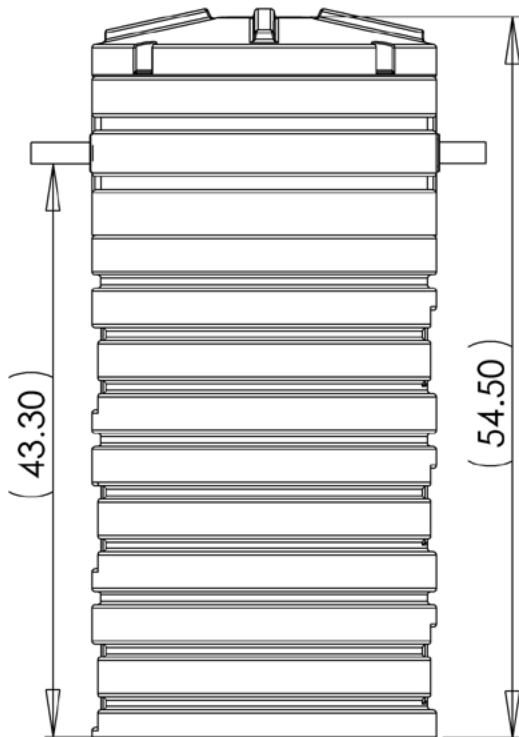

Components

RB-B-26x38: 26" x 38" Basin

RB-R-26x12: 26" x 12" Riser

RB-L-26: 26" Lid

P-TE-10/20/30: 1/2 hp, 10, 20 or 30 gpm Turbine Effluent Pump

PDS-TD-1.25: 1.25" Turbine Discharge

PDS-GT-1.25: 1.25" Rubber Grommet

PDS-GT-4.0: 4" Rubber Grommet

AC-JSB: Junction Splice Box with 4 Cord Grips

AC-CP-S-C: Simplex Contactor Control Panel

PDS-GT-1.50: 1.50" Rubber Grommet

Warranty for Defects in Material and Workmanship

- Pump - 3 Years
- Alarms/Controls - 3 Years
- Risers and Lids - 2 Years
- All other components - 2 Years



P.O. Box 1520, Crestwood, Ky, 40014

Copyright 2006, Quanics Incorporated, All rights reserved
Product(s) covered by one or more U.S. and/or International patents. Other U.S. and International patents may be pending.